

LHY - LHY Series

2.54mm (0.1 in.) Pin Header

For 02 to 40 Contacts Straight and Right Angle Options, Single Row

Application and Features

Notches for easy breakable.

Variable pin length, Gold or Tin plated.

Standoffs facilitate post soldering clean.

Recommended Part Mating:

PACX PBFY PCFY PDFY PFFY PGFY PHA PHFY PMFY PSFY PWFY QPHFY SPGFAY SPGFY

Specifications

Contact Material	Copper Alloy
Contact Resistance	20m ohms max
Current Rating	3 Amps
Dielectric Withstanding	AC 1000 V
Duplex Plating	Gold plated on Contact Area, Tin on Solder Area
Environmental	RoHS Compliant
Finish	Tin, Gold or Duplex plated
Insulator Material	Polyester, UL 94V-0 @ Standard:Nylon-6T
Insulator Resistance	5000 Megohms min
Operating Temperature	-40° ~ +105° C
Standard	Gold flash all over

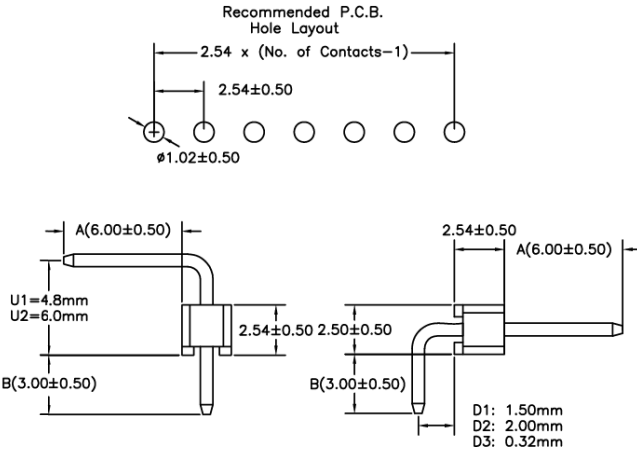
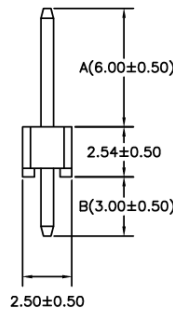
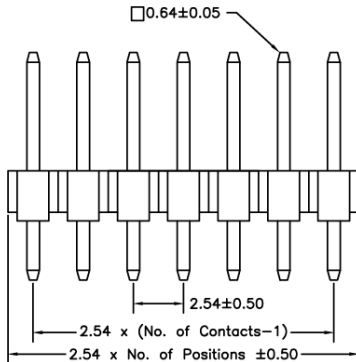
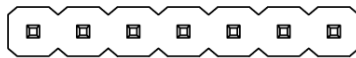
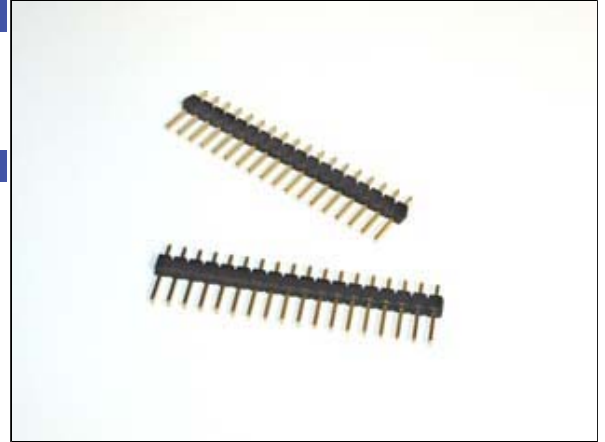

unit:mm

How to Order

Please replace "X" with appropriate coding listed in the tables below.

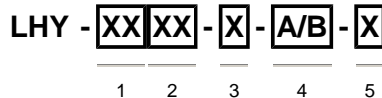

Item	Description	Options
1	Number of Contacts	02, 03, 04, 05, 06, 07, 08, 09, 10, 11, 12, 13, 14, 15, 16, 17, 18, 19, 20, 21, 22, 23, 24, 25, 26, 27, 28, 29, 30, 31, 32, 33, 34, 35, 36, 37, 38, 39, 40
2	Connector Type	Straight=S, Up Angle 4.8mm=U1, Up Angle 6.0mm=U2, Down Angle 1.5mm=D1, Down Angle 2.0mm=D2, Down Angle 0.32mm=D3
3	Contact Plating	Tin Plated=VA, Gold Flash=VB, Gold 3u"=VC, Gold 5u"=VD, Gold 10u"=VE, Gold 15u"=VF, Gold 30u"=VJ, Duplex Flash=VK, Duplex 3u"=VL, Duplex 5u"=VM, Duplex 10u"=VN, Duplex 15u"=VP, Duplex 30u"=VU
4	Pin Length	A- 6.0 mm/B- 3.0 mm=060/030
5	Environment Type	High Temp RoHS Compliant=FG